



9. Remove screws of OEM radio

Take out OEM radio
(pull out plugs carefully)



10. Fix mounting brackets to
Double DIN Navigation

Connect all required circuit
points of Double DIN
Navigation
Place it on dashbord. Fix it
with OEM screws

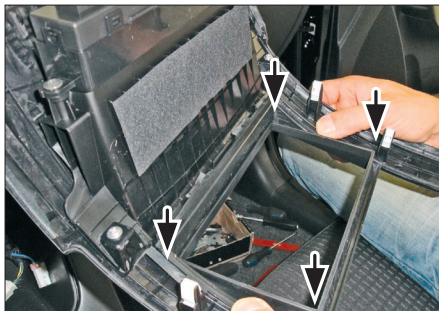

11. Mount facia plate to OEM panel



12. Install everything in reverse order
to finish installation

Kia Sorento 2010->

Compatible with these double DIN devices

Double DIN Navigation

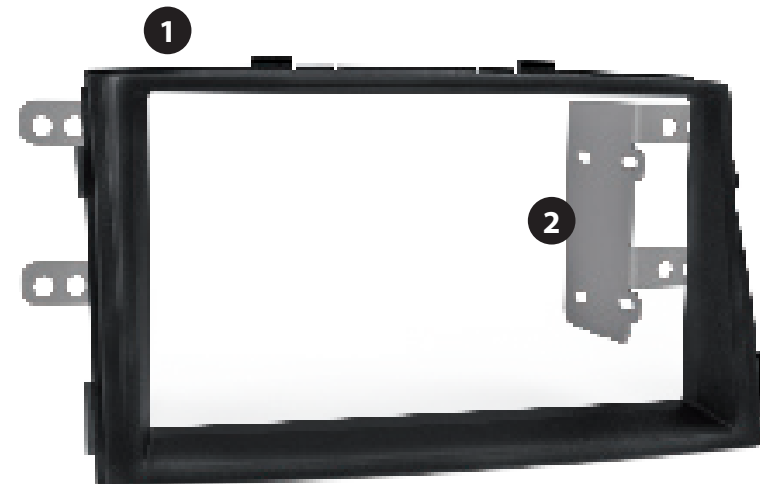

(1) Facia Plate
(2) Mounting brackets (left / right)



1. Remove plastic rivets at left and right side. remove panels

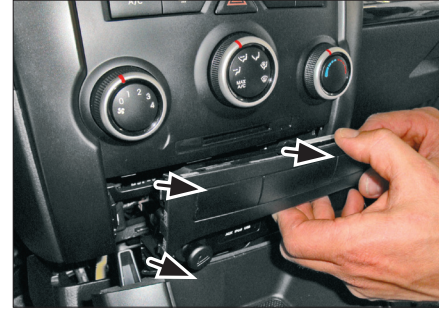

5. Unclip panel holding the cigarette lighter and remove it (pull out plugs carefully)



2. Remove screws

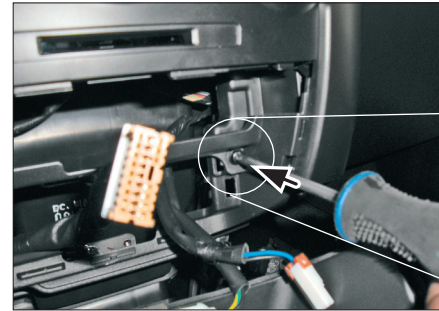

6. Remove 2 screws which became visible



3. Remove plastic cover remove 3 screws

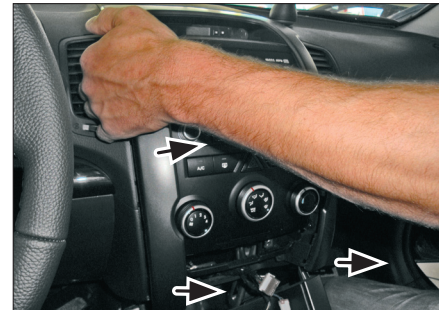
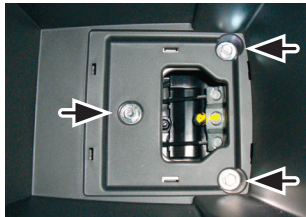

7. Remove center panel (pull out plug at top carefully!)



4. Pull hand brake at highest position

Pull gear lever towards your direction

Pull center console towards your direction as much as possible



8. Remove screws of air condition control unit and remove it (pull out plugs carefully)